



Island Associates Real Estate Inc.

We create value

**18,168 SF Warehouse Space Available  
w/ Dedicated Office Space  
181 Freeman Ave., Islip, NY**



**Roger A. Delisle, Jr. CCIM**  
[roger@islandassociates.com](mailto:roger@islandassociates.com)



**Chris Mayor**  
[Chris@IslandAssociates.com](mailto:Chris@IslandAssociates.com)  
**(631) 513-2000**

**Larry Densen**  
[Larry@IslandAssociates.com](mailto:Larry@IslandAssociates.com)  
**(516) 857-5564**

## Property Information

**+/- 18,168 SF Warehouse/Office Space Available**

Lease Price: \$15.00/ SF Gross (Utilities Metered Separately)

Demographics	1 Mile	3 Miles	5 Miles
Total Population	12,919	116,199	217,425
Median HH Income	\$93,828	\$85,323	\$87,685



- ❖ 17' Under Steel Ceiling Heights
- ❖ 1 Loading Dock & 2 additional Overhead Doors
- ❖ Easy access off Route 111 and Southern State Parkway
- ❖ 450 Parking Spaces
- ❖ Executive Office Space with Separate Entrance
- ❖ Join Gold's Gym, Parisi Speed School & Dance Connection

All information is subject to errors, omissions, modification, and withdrawal.  
Information is from sources deemed to be reliable but should not be relied upon without independent verification.

## Property Information

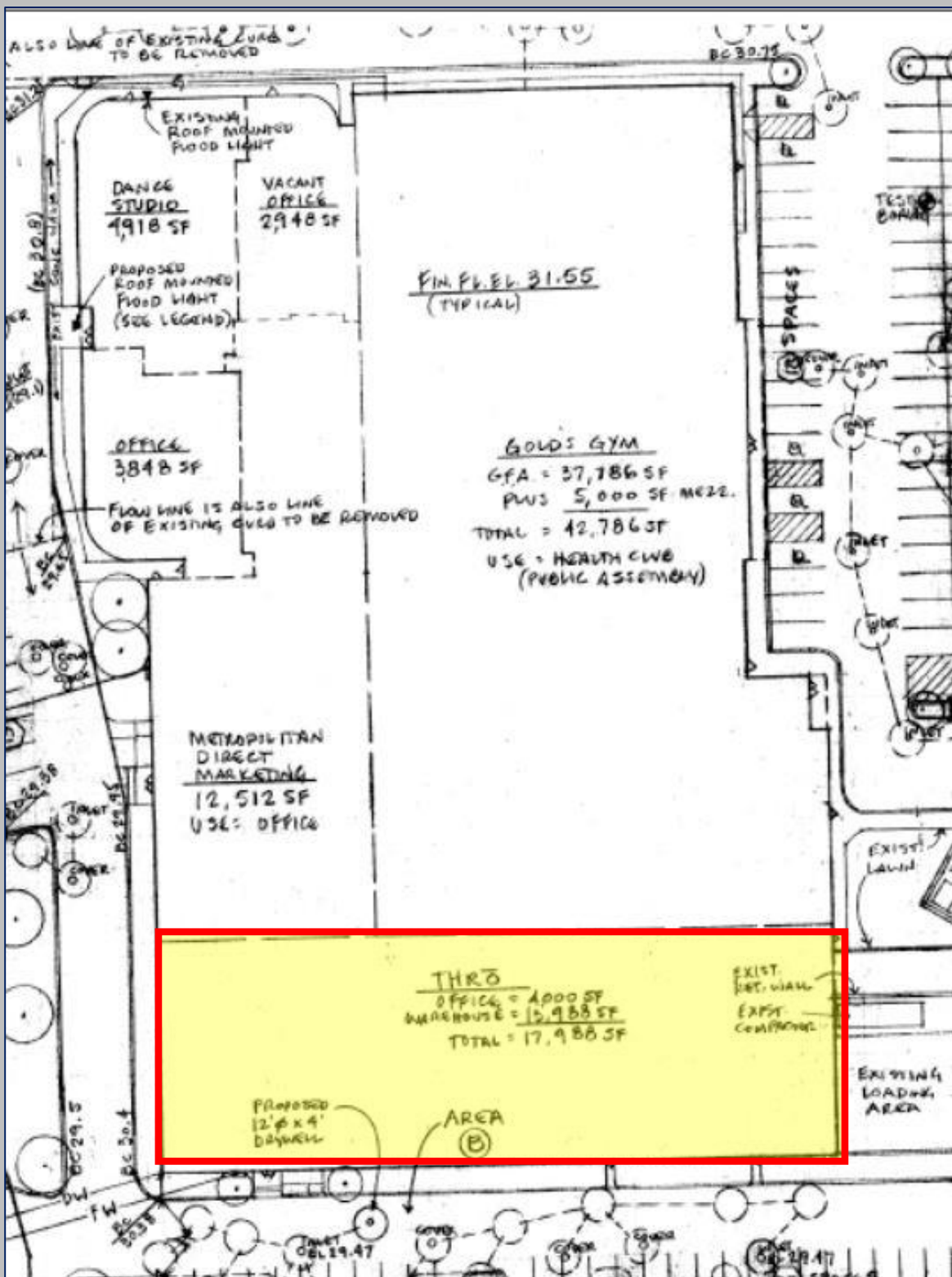

*All information is subject to errors, omissions, modification, and withdrawal.*

*Information is from sources deemed to be reliable but should not be relied upon without independent verification.*



## Property Information

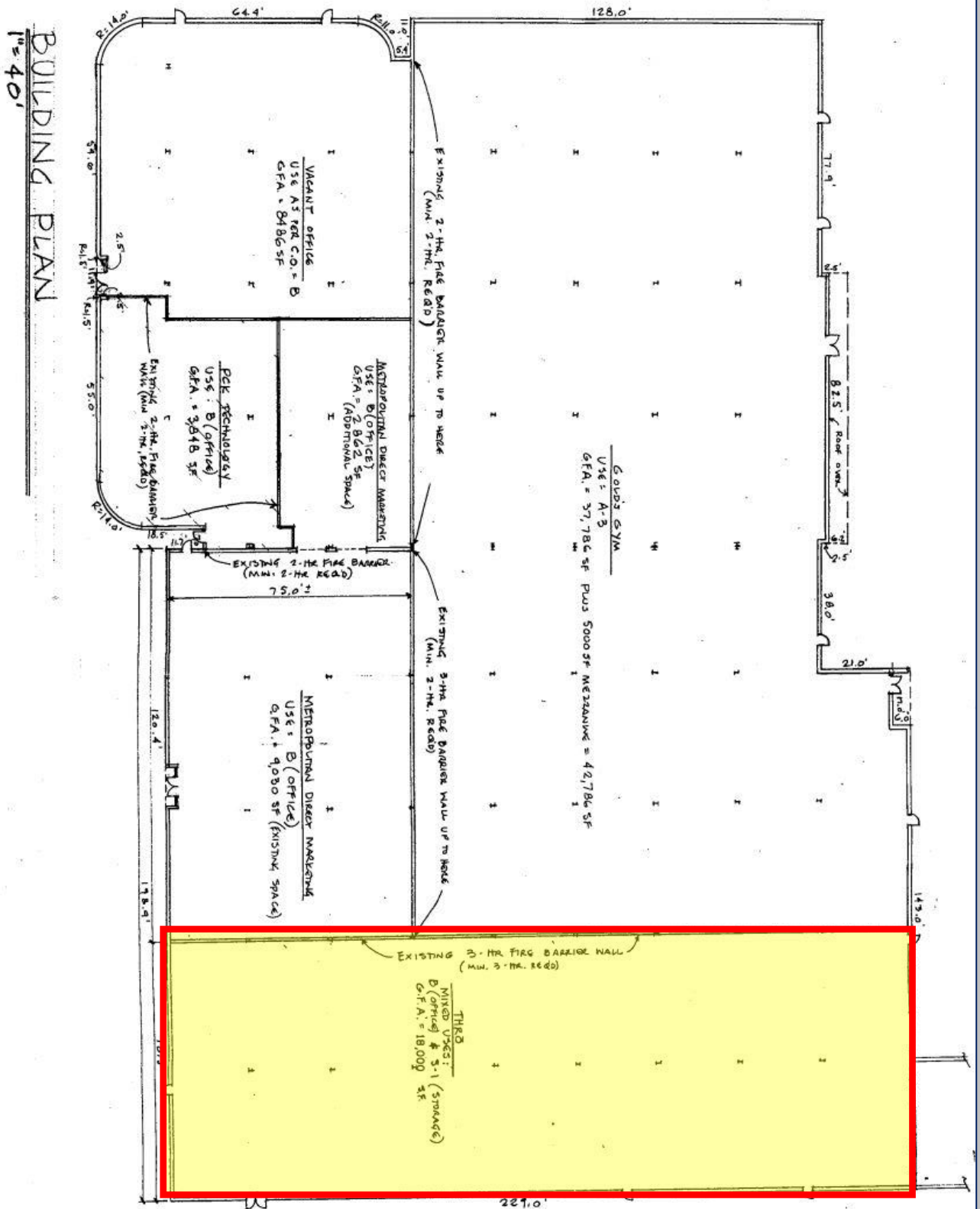

*All information is subject to errors, omissions, modification, and withdrawal.*

*Information is from sources deemed to be reliable but should not be relied upon without independent verification.*